

KAABC & KAABS INSTALLATION INSTRUCTIONS

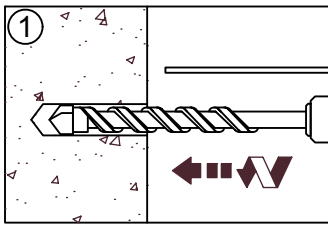

1. DRILL A HOLE TO ALLOW FOR THE PROPER EMBEDMENT DEPTH (SEE CHART BELOW). IF REBAR IS ENCOUNTERED, CONTACT THE PROJECT STRUCTURAL ENGINEER OF RECORD FOR INSTRUCTION BEFORE PROCEEDING.

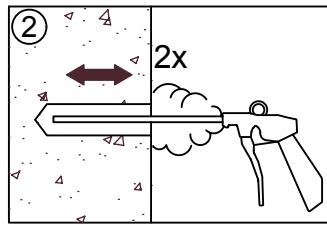

2. CLEAN HOLE WITH COMPRESSED AIR OR A HAND PUMP TO REMOVE DRILLING DEBRIS. 2X

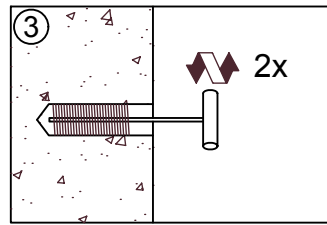

3. BRUSH THE HOLE TWICE WITH BRUSH THE SAME SIZE AS THE HOLE. 2X

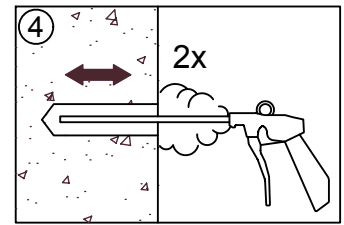

4. CLEAN HOLE AGAIN WITH COMPRESSED AIR. 2X

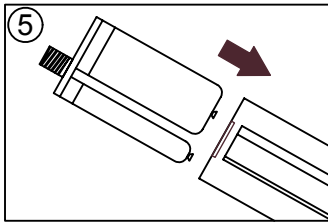

5. INSERT FOIL PACK IN FOIL PACK HOLDER

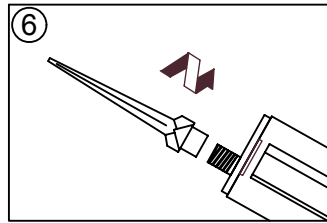

6. ATTACH MIXER TIGHTLY TO FOIL PACK MANIFOLD.

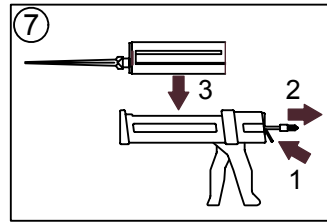

7. INSERT FOIL PACK HOLDER WITH FOIL PACK INTO DISPENSER.

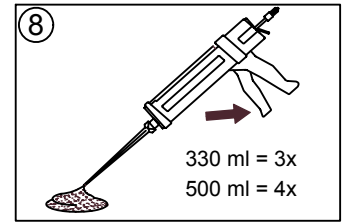

8. DISCARD THE INITIAL ADHESIVE.

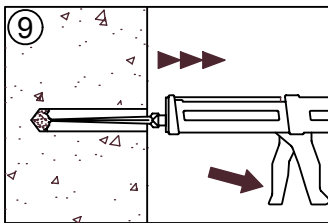

9. INJECT THE ADHESIVE, STARTING AT THE BACK OF THE BOREHOLE. FILL HOLES APPROXIMATELY 2/3 FULL, OR AS REQUIRED TO ENSURE THAT THE GAP BETWEEN THE ANCHOR AND THE CONCRETE IS COMPLETELY FILLED ALONG THE EMBEDMENT DEPTH.

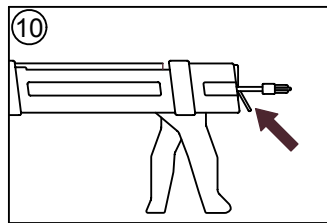

10. AFTER THE INJECTION IS COMPLETED, DEPRESSURIZE THE DISPENSER..

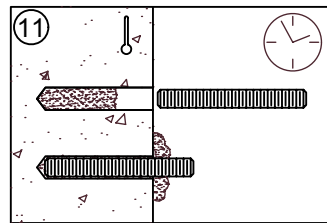

11. INSERT ANCHOR INTO THE BOREHOLE. MARK & SET THE ANCHOR TO THE REQUIRED EMBEDMENT DEPTH. THE GAP BETWEEN THE ANCHOR AND THE CONCRETE SURFACE OF THE BOREHOLE MUST BE COMPLETELY FILLED WITH ADHESIVE.

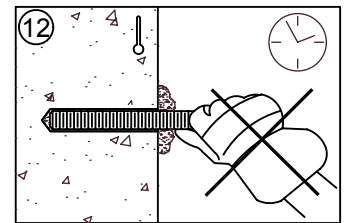

12. DO NOT DISTURB THE ANCHOR UNTIL CURE TIME (t cure, initial) HAS PASSED (SEE CHART BELOW). THE ANCHOR HAS LIMITED CAPACITY AT THIS TIME DO NOT APPLY A TORQUE OR A LOAD.

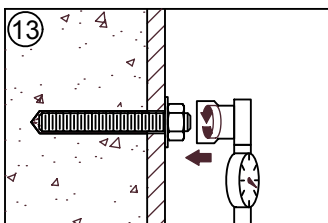

13. AFTER THE FULL CURE TIME (t cure, full) HAS PASSED, THE MEMBER TO BE ATTACHED MAY BE POSITIONED AND A LOAD/TORQUE MAY BE APPLIED.

ANCHOR BOLT EMBEDMENT CHART					
BOLT SIZE		HOLE DIAMETER		EMBEDMENT DEPTH	
(IN)	(MM)	(IN)	(MM)	(IN)	(MM)
3/8	10	0.44	11	3.00	76
1/2	13	0.56	14	4.00	102
5/8	16	0.75	19	5.00	127
3/4	19	0.88	22	6.00	152
7/8	22	1.00	25	7.00	178
1	25	1.13	29	8.00	203
1 1/4	32	1.38	35	10.00	254

CURE TIME CHART			
TEMPERATURE		t cure, initial	t cure, full
° F	° C	(hours)	(hours)
41	5	18	72
50	10	12	48
59	15	8	24
68	20	6	12
86	30	4	8
104	40	2	4



KINETICS NOISE CONTROL, INC
6300 IRELAN PL,
DUBLIN, OH 43017 USA
Ph: 614 889-0480, Fax: 614 889-0540
www.kineticsnoise.com

By: BB
Date: 10/18/10
Revised: 11/15/11 /DCB

Drawing No:
INS-52.032-1A