

# MODEL ISOMAX:

## NEW FIRE-RATED FLOOR/CEILING ASSEMBLY

	Model IsoMax by Kinetics Noise Control	Non-IsoMax Assembly	Non-IsoMax Assembly
UL Design	L583	L528	L576
Rating (Hrs)	1	1	1
Finish Rating (Min)	58	22	25
Sub-flooring	23/32" plywood T&G	23/32" plywood T&G	23/32" plywood
Finish Flooring	None	None	<b>1x4 T&amp;G lumber</b>
Structural Member	Parallel Chord Trusses, or Wood "I" Joist, or Wood and Steel Trusses, or 2x10 and Larger Joists	Parallel Chord Trusses	Parallel Chord Trusses
Insulation	6-1/4" fiber glass blanket draped over furring channel	Adding fiber glass in cavity <b>REQUIRES 2nd layer of drywall *</b>	Adding 3.5" fiber glass <b>REQUIRES tighter clip spacing and twice as many joists</b>
Furring Channel Spacing (o.c.)	24"	24"	16" (12" w/ fiber glass)
Clip Spacing (along furring channel)	48"	48"	48" (12" w/ fiber glass)
Butt Joints	Along existing furring channel	<b>Extra clips and furring channel REQUIRED at butt joints</b>	<b>Extra clips and furring channel REQUIRED at butt joints</b>
Clips Needed **	<b>35 IsoMax</b>	<b>70</b> (113 w/ fiber glass)*	<b>87</b> (285 w/ fiber glass)
Furring Channel Needed (LF) **	<b>115.5</b>	<b>179.5</b> (267.5 w/ fiber glass)*	<b>229</b> (278.5 w/ fiber glass)
Gypsum	2 layers, 5/8" Type C	1 layer, 5/8" Type C (2 layers, w/ fiber glass)*	1 layer, 5/8" Type C

### \*From UL BXUV.GuidelInfo – Fire Resistance Ratings – ANSI/UL 263

#### Part III Floor-Ceilings and Roof-Ceilings, Section 18: Blanket Insulation:

Unless specifically described in a design, the addition of insulation in the concealed space between the ceiling membrane and the floor or roof structure may reduce the hourly rating of an assembly by causing premature disruption of the ceiling membrane and/or higher temperatures on structural components under fire exposure conditions.

**Insulation in G500, L500 and P500 Series Designs** — For 1-hour rated G500, L500 and P500 series assemblies, fiberglass insulation, either loose-fill, batts or blankets may be added to the plenum or joist space above the gypsum wallboard provided an additional layer of gypsum wallboard is added to the assembly. The gypsum wallboard should be of the same type as shown in the individual designs. The base layer of wallboard should be attached with the fastener type and spacing as described in the design. It is not necessary to tape the joints of the base layer. The finish layer of gypsum wallboard should also be attached with the fastener type and spacing as described in the individual design. The length of the fasteners should be increased by a minimum of the wallboard thickness of the additional layer. The joints in the finish layer should be finished as described in the design.

Other methods of adding insulation in the plenum or joist cavity are not permitted unless indicated in the individual designs.

**\*\* Clip and furring channel requirements based on 16.5 ft by 12.5 ft rectangular spaced room**

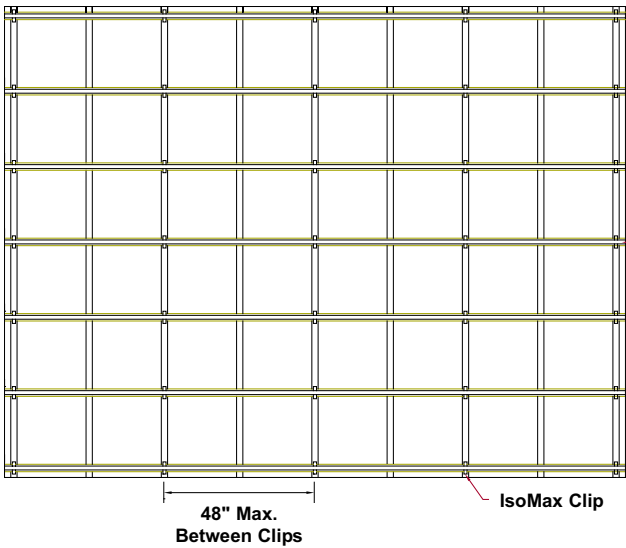

**UL L583 w/ fiber glass**  
**35 IsoMax Clips**  
 115.5 ft of furring channel

24" Max.  
Between  
Channels

Main Channel



48" Max.  
Between Clips

IsoMax Clip

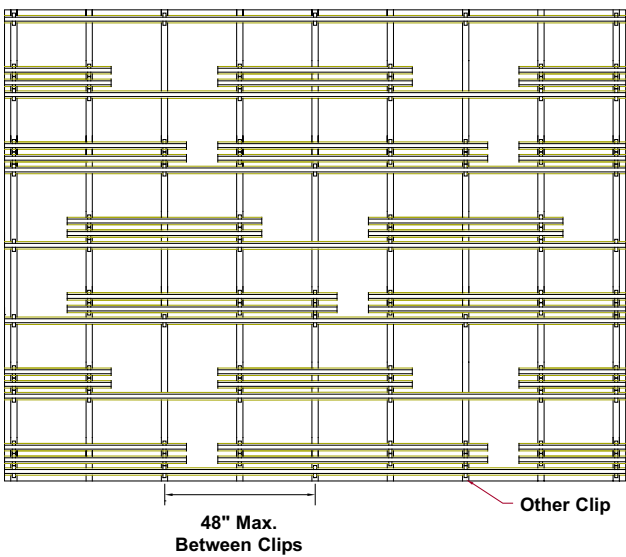

**UL L528 w/ fiber glass**  
 113 clips  
 267.5 ft of furring channel

24" Max.  
Between  
Channels

Main Channel

First Layer Butt Joint Channel

Second Layer Butt Joint Channel

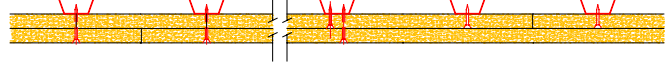

48" Max.  
Between Clips

Other Clip

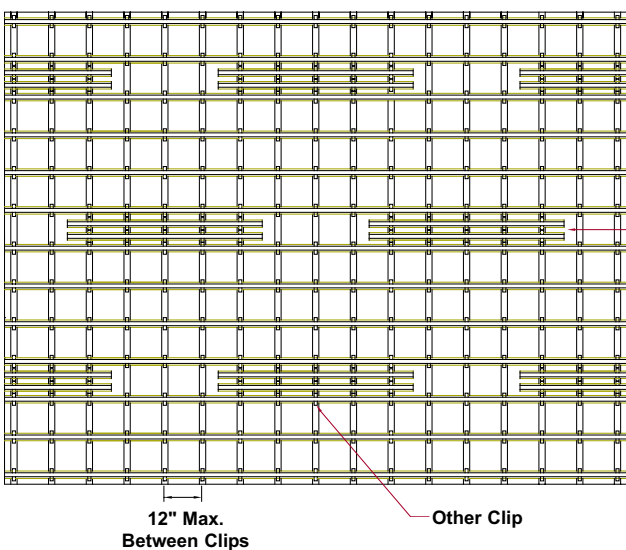

**UL L576 w/ fiber glass**  
 285 clips  
 278.5 ft of furring channel

12" Max.  
Between  
Channels

Butt Joint Channel

Main Channel

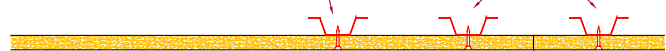

12" Max.  
Between Clips

Other Clip

The above construction practices should be reviewed with your local Code Official before construction. To get a copy of the UL Fire Resistance Directory Call (847) 272-8800, Ext. 42612 or 42622, or write to Underwriter's Laboratories, Inc., Publications Stock, 333 Pfingsten Road, Northbrook, IL 60062. There is a cost for the directory, so inquire first.



Kinetics Noise Control, Inc. • 6300 Irelan Place • Dublin, OH 43017 • Phone: 614-889-0480 • Fax: 614-889-0540  
 Web Site: [www.KineticsNoise.com](http://www.KineticsNoise.com) • E-mail: [ArchSales@KineticsNoise.com](mailto:ArchSales@KineticsNoise.com)