

STUD TYPE	UNIBRACE QUANTITY	UNIBRACE SPACING	PLYWOOD HEIGHT
WOOD	4	12"(305)	18"(457)
16 ga	4	12"(305)	18"(457)
18 ga	4	12"(305)	18"(457)
20 ga	REFER TO DWG# AA001951		
25 ga	--- NOT ACCEPTABLE ---		

UNIBRACE F  
INSTALLED  
WITH (3) #10  
WOOD SCREWS  
@ PLYWOOD  
BLOCKING

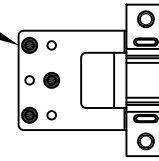

3/4" (19) PLYWOOD  
(GRADE C-C, EXP-1,  
FIR, 4 PLY). REFER  
TO CHART FOR  
REQUIRED HEIGHT.

CENTER TV MOUNTING  
BRACKET IN PLYWOOD  
BLOCKING

UNIBRACE F INSTALLED  
WITH (3) #10 WOOD  
SCREWS @ PLYWOOD  
AND (2) #10 SCREWS @  
STUDS. (TEK WHEN  
METAL STUDS & WOOD  
WHEN WOOD STUDS.)

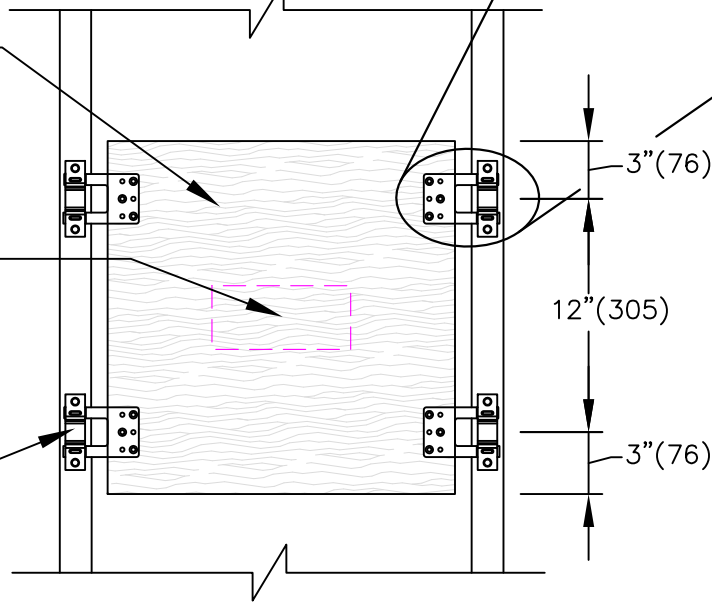

ELEVATION VIEW

**NOTE:**  
TV MOUNTING BRACKET TO BE CENTERED ON  
PLYWOOD BLOCKING; MAXIMUM TV WEIGHT IS 140 LBS.  
ARTICULATING TV ARM MOUNT CANNOT BE USED.

3/4" (19) PLYWOOD  
(GRADE C-C, EXP-1,  
FIR, 4 PLY). REFER  
TO CHART FOR  
REQUIRED HEIGHT.

UNIBRACE F INSTALLED  
WITH (3) #10 WOOD  
SCREWS @ PLYWOOD  
AND (2) #10 SCREWS  
@ STUDS. (TEK WHEN  
METAL STUDS & WOOD  
WHEN WOOD STUDS.)

ISOMAX CLIP WITH  
FURRING CHANNEL

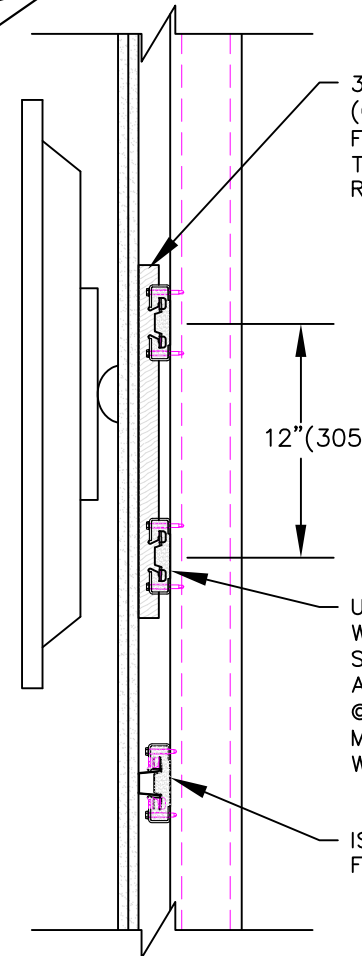

SECTION VIEW

DIMENSION FORMAT: IN (mm)



TITLE  
TV MOUNT WITH  
UNIBRACE F

LAST DATE  
REVISED  
04/08/11

DRAWN BY  
TJM

DRAWING NO.  
AA001950

AA

STUD TYPE	UNIBRACE QUANTITY	UNIBRACE SPACING	PLYWOOD HEIGHT
WOOD	REFER TO DWG# AA001950		
16 ga	REFER TO DWG# AA001950		
18 ga	REFER TO DWG# AA001950		
20 ga	6	12"(305)	30"(762)
25 ga	---	NOT ACCEPTABLE	---

UNIBRACE F  
INSTALLED  
WITH (3) #10  
WOOD SCREWS  
@ PLYWOOD  
BLOCKING

3/4" (19) PLYWOOD  
(GRADE C-C, EXP-1,  
FIR, 4 PLY). REFER  
TO CHART FOR  
REQUIRED HEIGHT.

CENTER TV MOUNTING  
BRACKET IN PLYWOOD  
BLOCKING

UNIBRACE F INSTALLED  
WITH (3) #10 WOOD  
SCREWS @ PLYWOOD  
BLOCKING AND (2) #10 SCREWS @  
STUDS. (TEK WHEN  
METAL STUDS & WOOD  
WHEN WOOD STUDS.)

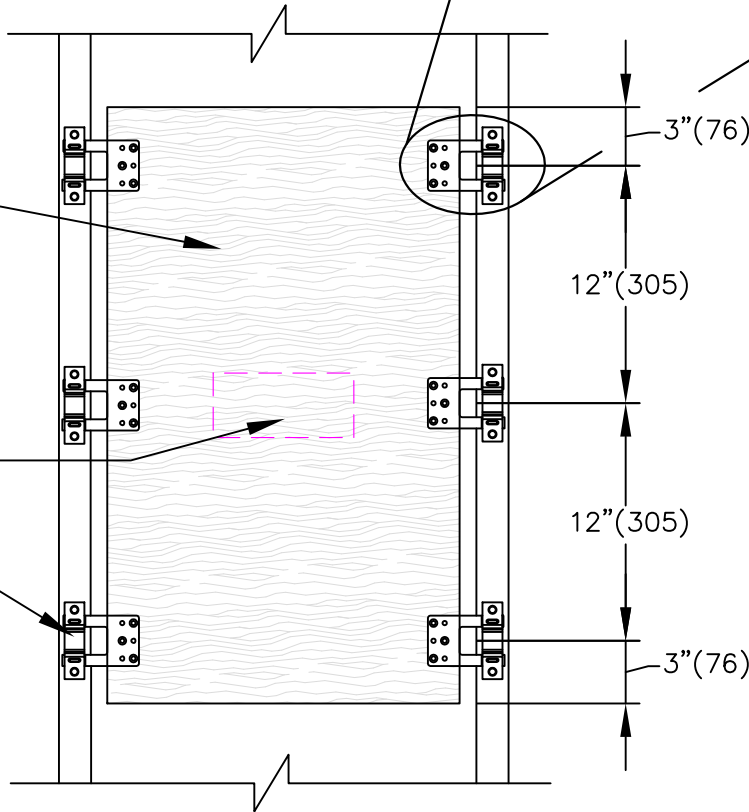

NOTE ELEVATION VIEW

TV MOUNTING BRACKET TO BE CENTERED ON  
PLYWOOD BLOCKING; MAXIMUM TV WEIGHT IS 140 LBS.  
ARTICULATING TV ARM MOUNT CANNOT BE USED.

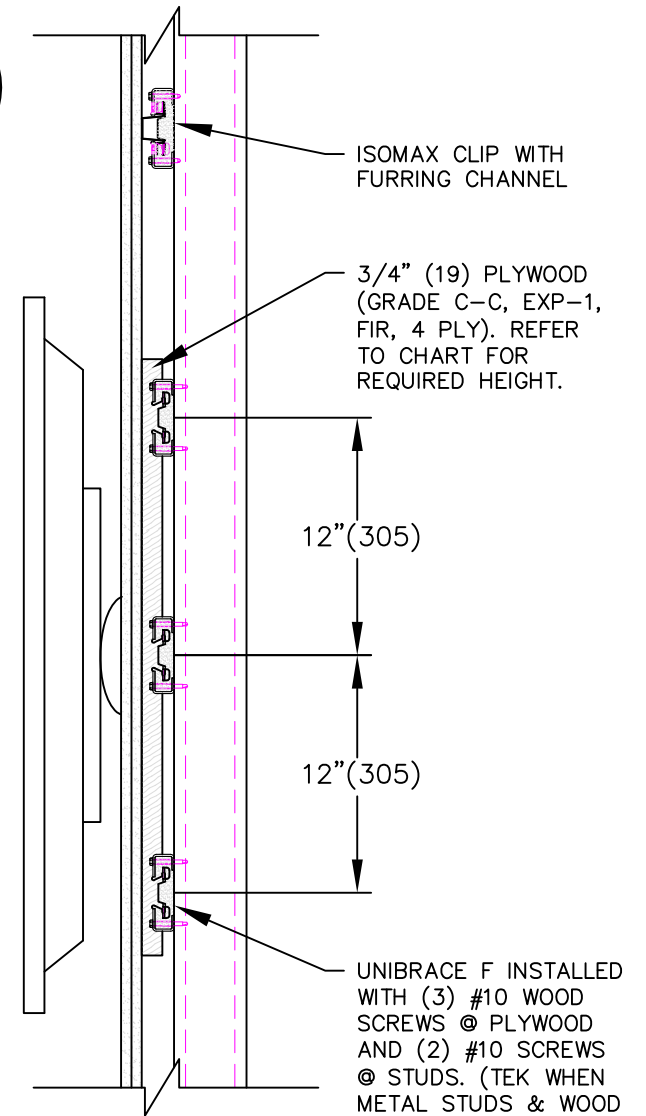

SECTION VIEW

UNIBRACE F INSTALLED  
WITH (3) #10 WOOD  
SCREWS @ PLYWOOD  
BLOCKING AND (2) #10 SCREWS  
@ STUDS. (TEK WHEN  
METAL STUDS & WOOD  
WHEN WOOD STUDS.)

DIMENSION FORMAT: IN (mm)

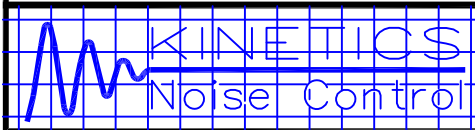

TITLE  
TV MOUNT WITH  
UNIBRACE F ON 20 GA STUD

LAST DATE  
REVISED  
04/08/11

DRAWN BY  
TJM

DRAWING NO. AA  
AA001951

# ISOMAX UNIBRACE F

IP UNITS (INCHES AND POUNDS)

A	B	C	D	E	F	G	H	J	K	L	M
3.86	3.86	1.06	0.22	3.11	0.71	2.53	1.78	0.89	0.84	0.28	0.61

<b>ISOMAX UNIBRACE F</b>
MAX. LOADING (LBS)
35.0

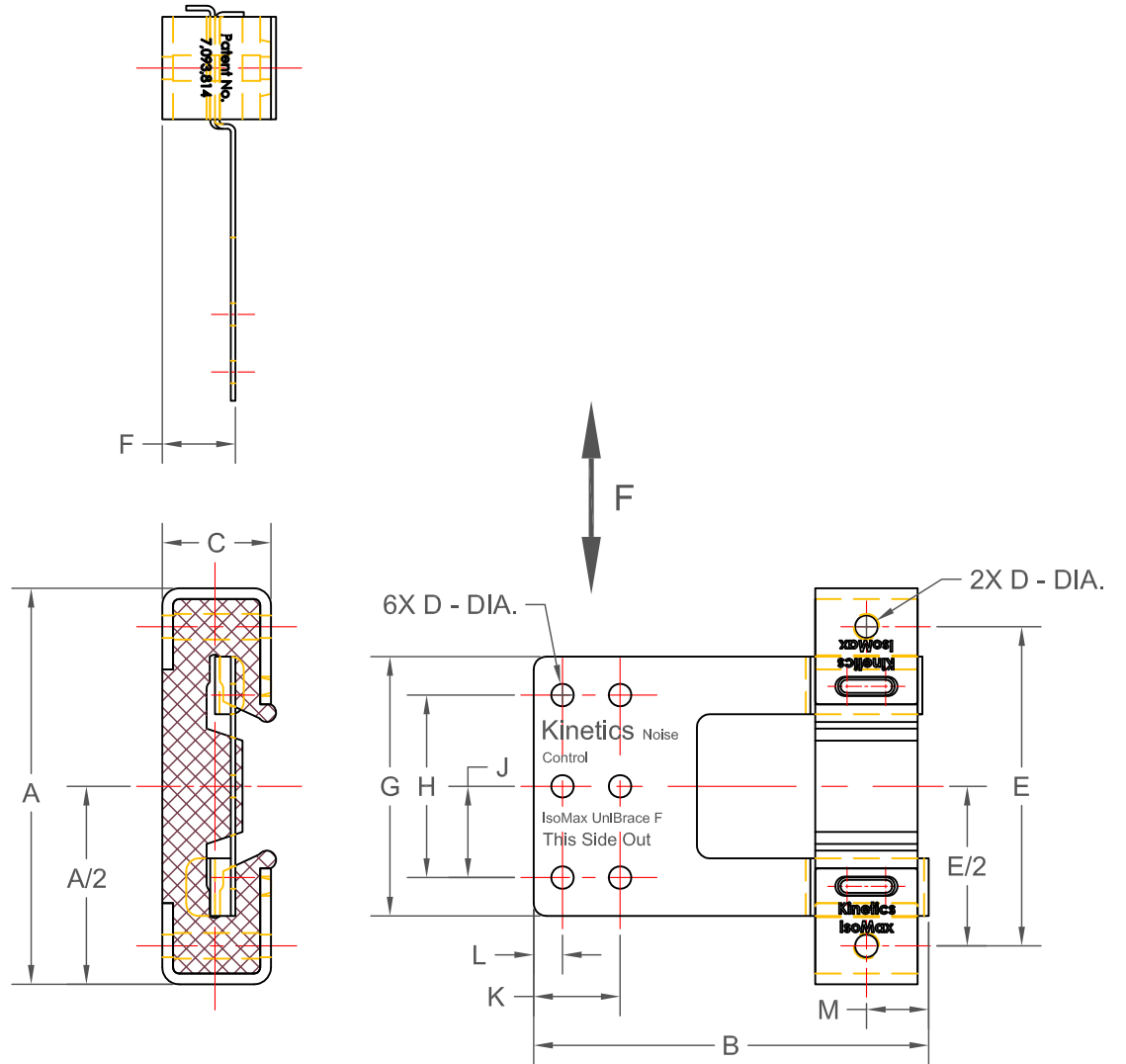

### SPECIFICATIONS:

- METAL COMPONENTS ARE PRE-GALVANIZED STEEL.
- ISOLATION ELEMENT IS NEOPRENE.



KINETICS NOISE CONTROL, INC  
6300 IRELAN PL,  
DUBLIN, OH 43017 USA  
Ph: 614 889-0480, Fax: 614 889-0540  
www.kineticsnoise.com

Model:  
**UNIBRACE F**

By: BB  
Date: 03/17/11  
Revised: /

Drawing No:  
**S-02.07-03**

# ISOMAX UNIBRACE F

SI UNITS (mm AND kg)

A	B	C	D	E	F	G	H	J	K	L	M
98	98	27	6	79	18	64	45	23	21	7	15

<b>ISOMAX UNIBRACE F</b>
MAX. LOADING (kg)
15.9

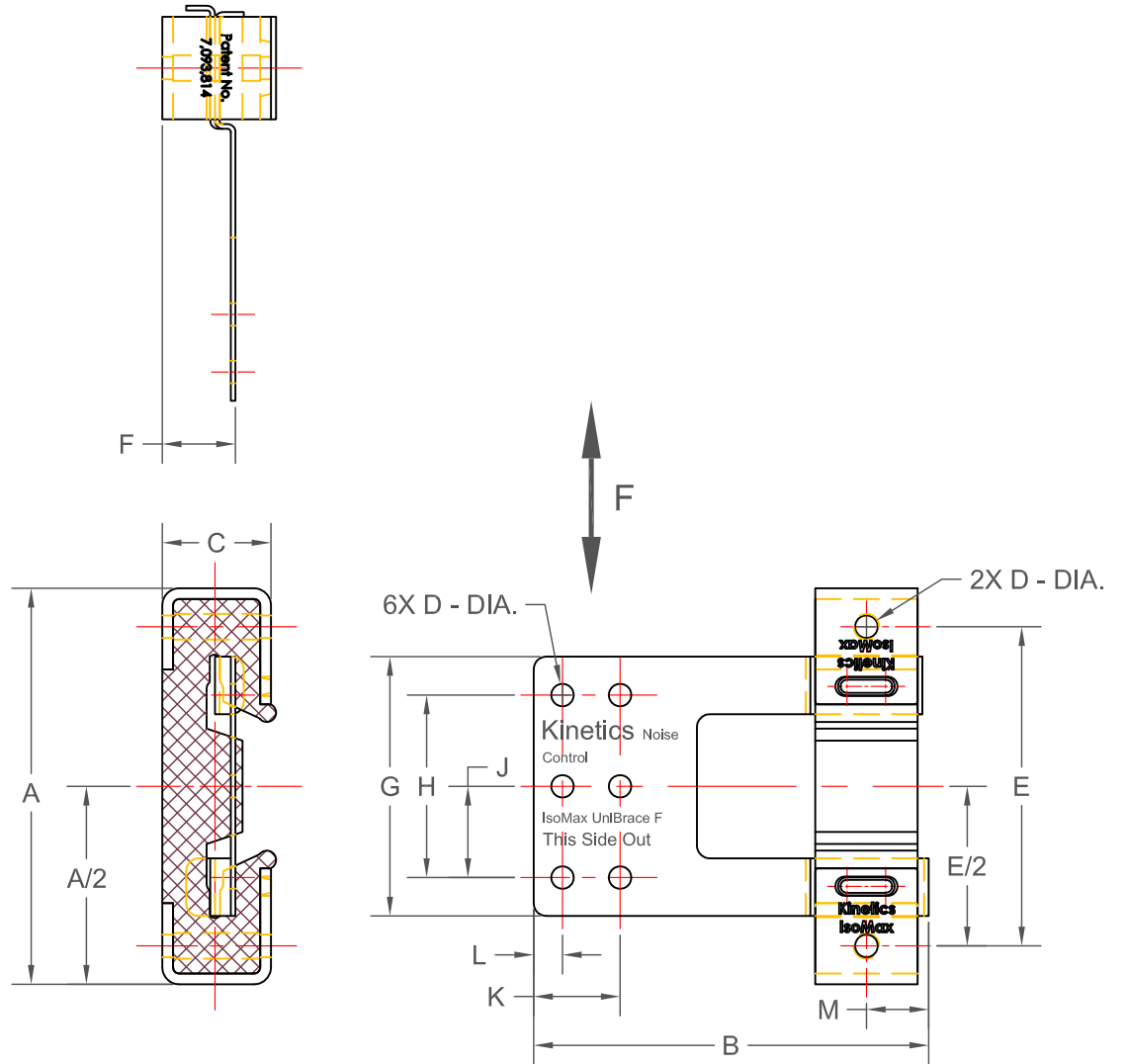

### SPECIFICATIONS:

- METAL COMPONENTS ARE PRE-GALVANIZED STEEL.
- ISOLATION ELEMENT IS NEOPRENE.



KINETICS NOISE CONTROL, INC  
 6300 IRELAN PL,  
 DUBLIN, OH 43017 USA  
 Ph: 614 889-0480, Fax: 614 889-0540  
 www.kineticsnoise.com

Model:  
**UNIBRACE F**

By: BB  
 Date: 03/17/11  
 Revised: /

Drawing No:  
**S-02.07-03**  
**METRIC**