

Quick Connect Ceiling Hanger

Model IsoGrid

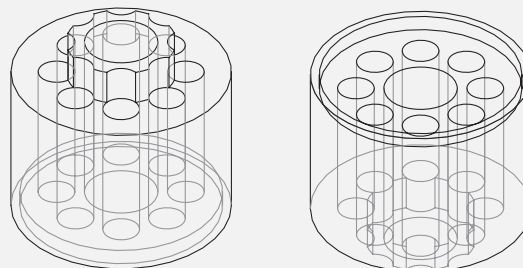

Dual Deflection Neoprene Isolator



Kinetics Noise Control Model IsoGrid utilizes our specially designed **Dual Deflection** neoprene isolator with internal bulge areas. These internal bulge areas allow the **Dual Deflection** neoprene element to achieve greater deflections than similarly sized elements while maintaining lateral stability. Greater deflection translates to greater performance for your noise control ceilings.

Benefits

- Dramatic labor savings over conventional ceiling hangers
- Meet code requirements while maximizing ceiling height
- Various attachment methods allow for installation on a variety of ceiling structures
- Easiest and quickest install of any ceiling hanger
- Known deflection rates ensure performance under design loads
- A built-in limit stop incorporated into the design ensures low cost and trouble free installation without acoustical short-circuit

Ceiling Isolation Theory

Resiliently suspended ceiling systems are designed to minimize floor impact noise and airborne sound transmissions through the floor/ceiling structure. Creating airspace and resiliently decoupling the

mass of the isolated ceiling from the non-isolated structure can effectively control noise transmission. Kinetics Noise Control ceiling isolation products use various types of resilient decouplers including springs, rubber or fiberglass pads, and combinations of pads and springs to improve Sound Transmission Class (STC) and Impact Insulation Class (IIC) values.

Application

Secured to concrete, metal deck, or structural framing, Model IsoGrid Quick-Connect Ceiling Hanger incorporates a neoprene element to resiliently support one or more layers of gypsum board. Attachment can be made directly into concrete by powder-actuated fastener through the hanger (where loads and local code permits). A lag screw can be used to screw into wood joists. Wire can then be tied to the bottom of the hanger bracket through the built-in mounting holes. Gypsum board is then installed using either drywall ceiling grid or cold rolled and hat channel.

Quick Connect Ceiling Hanger

Model IsoGrid

Acoustical Tests

6" Concrete Slab

Model IsoGrid Ceiling Hanger

6" Airspace Filled with Fiberglass batts

Cold Rolled Channel

Hat Channel

2 Layers 5/8" Drywall

STC 63

IIC 50

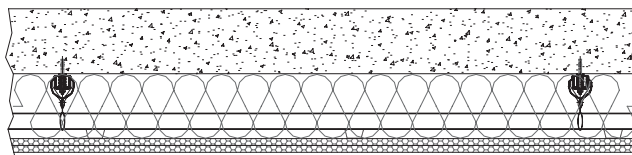

Test Number 02152

Selection Guide

Model	Maximum Capacity (lbs.)	Maximum Deflection (in.)	Layers of Drywall*	Dot Color
40	41	0.20	1	White
105	106	0.20	2	Green
160	158	0.20	3	Red

*Based on IsoGrid 4'x4' on center spacing

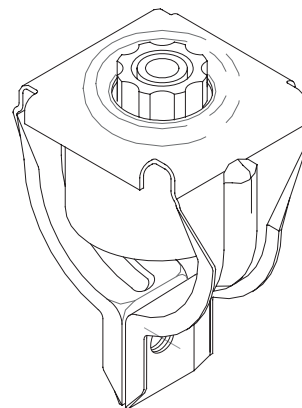

3 Step Quick-Connect Installation

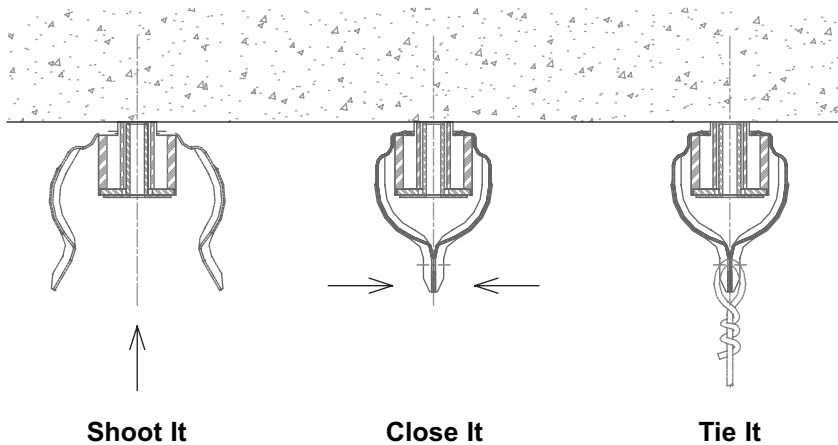

United States

6300 Irelan Place
P.O. Box 655
Dublin, Ohio 43017
Phone: 614-889-0480
Fax: 614-889-0540

Canada

3570 Nashua Dr.
Mississauga, Ontario
L4V 1L2
Phone: 905-670-4922
Fax: 905-670-1698

www.kineticsnoise.com
archsales@kineticsnoise.com

Kinetics Noise Control, Inc. is continually upgrading the quality of our products. We reserve the right to make changes to this and all products without notice.

Download Model IsoGrid information including three-part specification, installation guidelines, and typical installation drawings at www.kineticsnoise.com/arch/isogrid.aspx. Call the factory at 800-959-1229 if needing additional information; ask for Architectural sales. Purchase Model IsoGrid and accessories through your local sales representative (www.kineticsnoise.com/replacement.asp).