

1) ATTACH NOMINAL 2 x 4 WOOD BLOCKING TO THE TOP AND BOTTOM CORDS WITH (4) NAILS OR SCREWS.

NOTE: Truss/Joist manufacturer must approve hanger spacing and resulting point loads with ICW hanger supported ceiling on the selected truss/joint.

PER UL DESIGN NO. L581, INSTALLER SHOULD SELECT EITHER OPTION #1 OR OPTION #2 FOR ATTACHMENT OF ICW HANGER.

TRUSS/JOIST DESIGNER: HANGERS ARE TYPICALLY SPACED 48" ON CENTER BOTH WAYS. (SEE DRAWING AD-ICW00003)

NOT TO SCALE

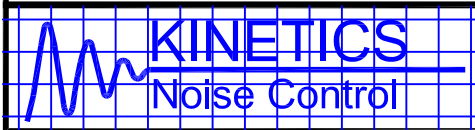

TITLE ICW HANGER
ATTACHMENT TO OPEN
WEB WOOD TRUSS (TYPICAL)

LAST DATE
REVISED
6/8/07

REVISED BY
MDV

DRAWING NO.
AD-ICW00002

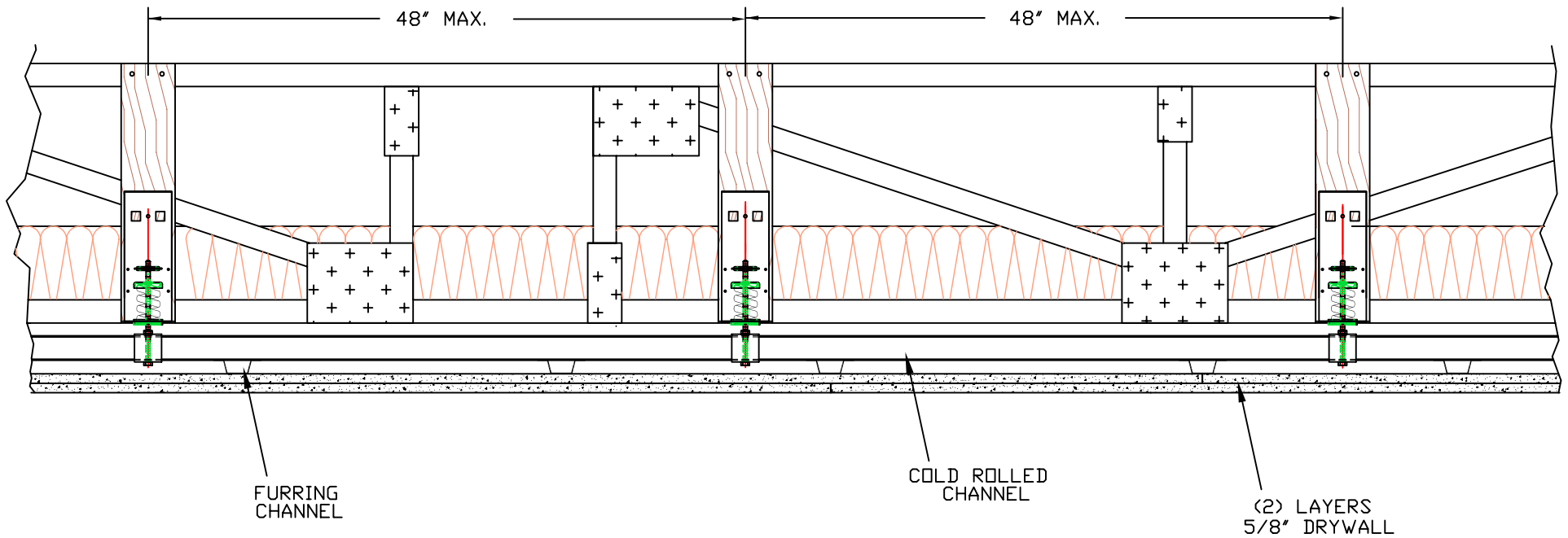

NOTE: Truss/Joist manufacturer must approve hanger spacing and resulting point loads with ICW hanger supported ceiling on the selected truss/joint.

TRUSS/JOIST DESIGNER: HANGERS ARE TYPICALLY SPACED 48" ON CENTER BOTH WAYS.

NOT TO SCALE



TITLE ICW HANGER
LAYOUT ON OPEN WEB
WOOD TRUSS

LAST DATE
REVISED
6/8/07

REVISED BY
MDV

DRAWING NO.
AD-ICW00003