

INSTALLATION OF WOOD BLOCKING

- 1) ATTACH WOOD BLOCKING WITH DRYWALL SCREWS (4 MINIMUM) AS SHOWN.
 OPTIONAL: BOND NOMINAL 2 x 4 WOOD BLOCKING TO I JOIST WEB WITH WOOD GLUE.

PER UL DESIGN NO. L581, INSTALLER SHOULD SELECT EITHER OPTION #1 OR OPTION #2 FOR ATTACHMENT OF ICW HANGER.

NOTE: Truss/Joist manufacturer must approve hanger spacing and resulting point loads with ICW hanger supported ceiling on the selected truss/joint.

TRUSS/JOIST DESIGNER: HANGERS ARE TYPICALLY SPACED 48" ON CENTER BOTH WAYS. (SEE DRAWING AD-ICW00005)

NOT TO SCALE

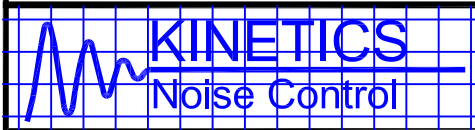

TITLE ICW HANGER
 ATTACHMENT TO ENGINEERED
 WOOD I-JOIST (TYPICAL)

LAST DATE
 REVISED
 6/8/07

REVISED BY
 MDV

DRAWING NO.
 AD-ICW00004

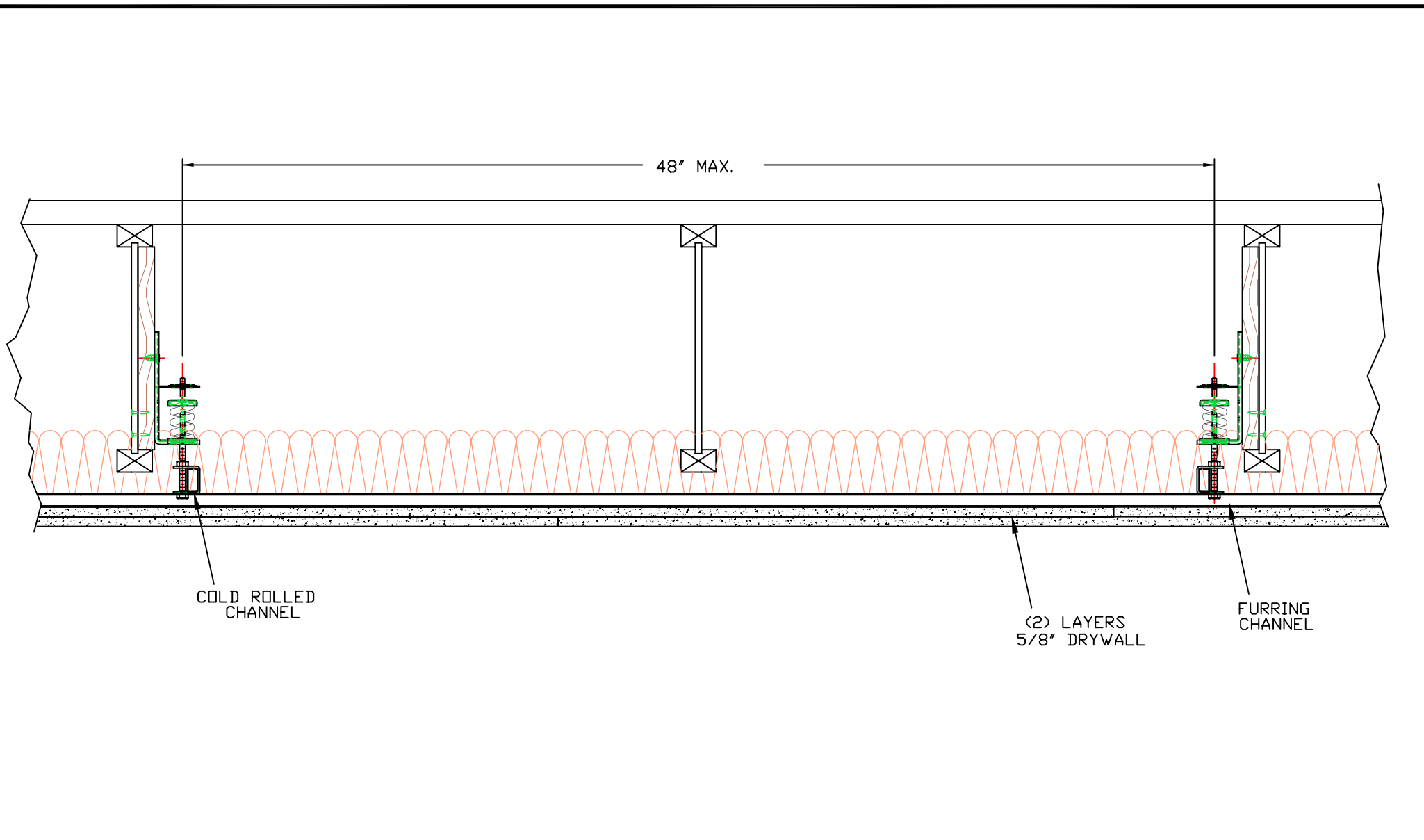

NOTE: Truss/Joist manufacturer must approve hanger spacing and resulting point loads with ICW hanger supported ceiling on the selected truss/joint.

TRUSS/JOIST DESIGNER: HANGERS ARE TYPICALLY SPACED 48" ON CENTER BOTH WAYS.

NOT TO SCALE



TITLE ICW HANGER LAYOUT ON ENGINEERED I-JOISTS

LAST DATE REVISED 6/8/07

REVISED BY MDV

DRAWING NO. AD-ICW00005